

Product Details

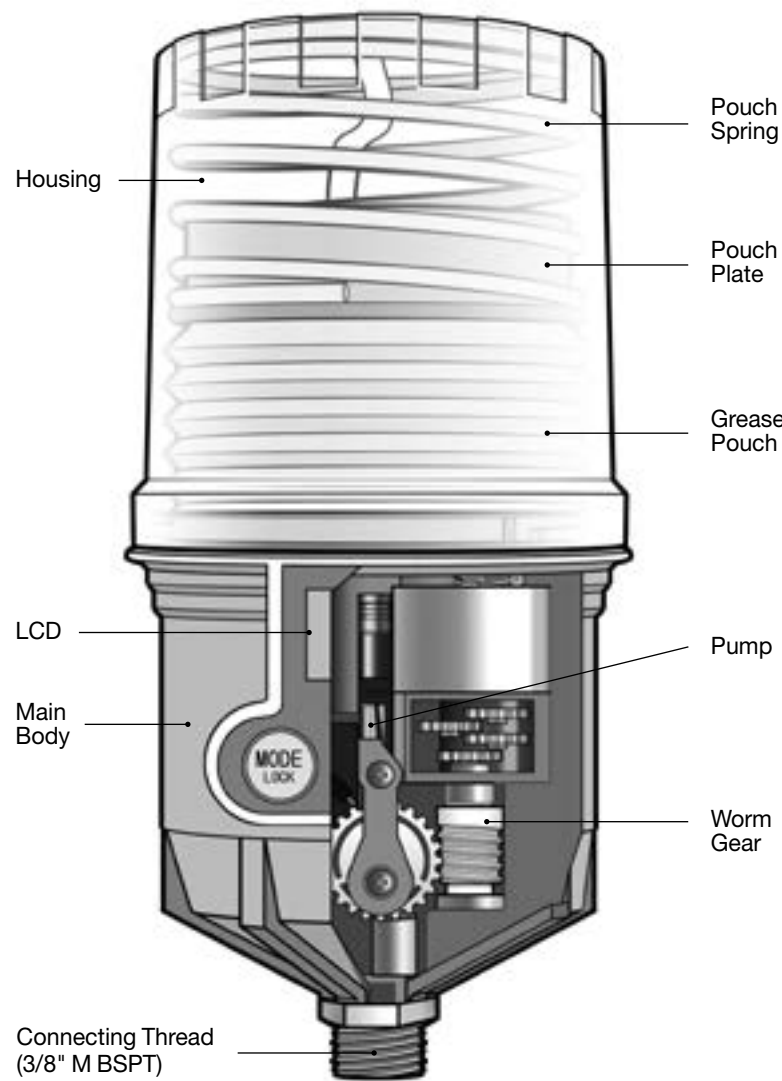

Installation/Disposal Guidelines

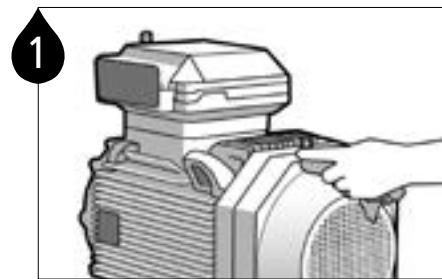

1 Remove contaminants around the lube point.

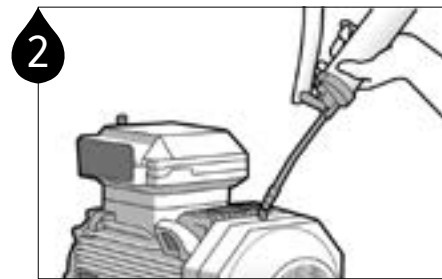

2 Ensure a clear passage using a manual grease gun. **Note1** Remove any hardened grease by purging the lube point with a manual grease gun. **Note2** The grease in the equipment and the grease contained in the unit should be the same or compatible.

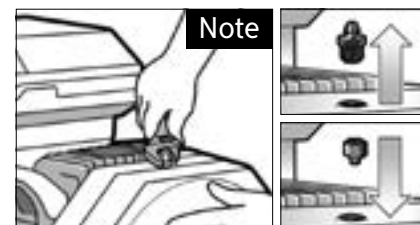

5 Remove the grease nipple and install appropriate adaptors.



3 Check the grease pouch capacity and the service pack items (battery pack, grease pouch & dust cover).



4 Insert a new battery pack.



5 Purge the grease pouch until grease comes out of the tip.

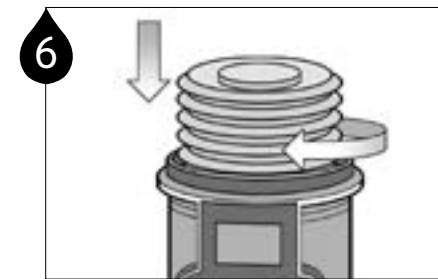

6 Carefully screw the grease pouch in by turning clockwise. Do not over tighten.

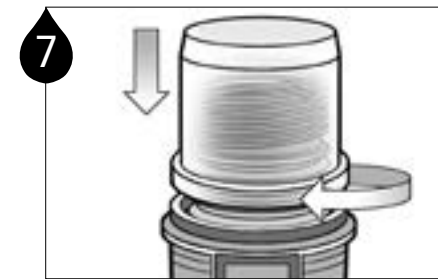

7 Refit the top housing on the unit and turn clockwise until it clicks.

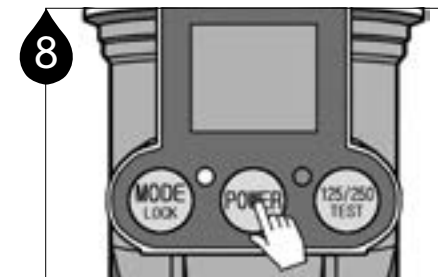

8 Press the POWER button for 2 seconds to turn the unit on



9 Select the appropriate grease pouch capacity by pressing the 125/250/TEST button.



10 Press the MODE button to program the dispensing period.



11 Press the TEST button for 2 seconds to run a test cycle and check for proper operation of the unit.

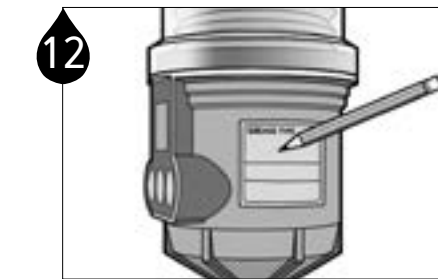

12 Note the installation date and the scheduled completion date of lube cycle on the lubricator using the label provided in the Service Pack for maintenance purposes.

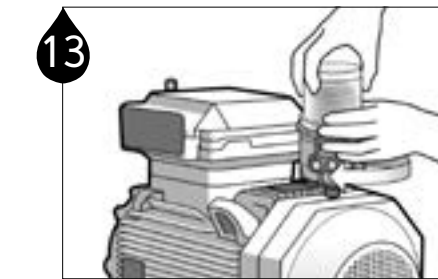

13 Install the PulsarLube EX unit on the lube point. When the selected dispensing period has completed, replace the unit with the Service Pack according to step #3-7.

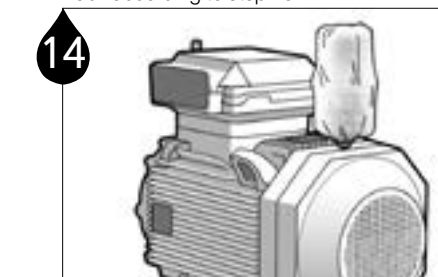

14 Install the dust cover over the lubricator for added protection.

Troubleshooting Guidelines



Symptom: Blank LCD screen
Possible Cause: Electrical malfunction of CPU or circuitry, battery problem
Solution: Replace battery pack or press reset button to restart the lubricator. If the problem persists, contact your supplier.



Symptom: Low Battery Indication
Possible Cause: Rapid power consumption due to improper storage or harsh operating conditions (temperature, humidity, or high backpressure).
Remedy: Store the battery pack in cool, dry place and choose proper battery type for application. Optional lithium battery pack is available for more advanced applications.



Symptom: Excessive Backpressure Indication
Possible Cause: Excessive backpressure due to hardened grease, over-lubrication, ruptured lube line, long distance remote installation, etc.
Solution: A) Check backpressure at lube point and/or lube line, B) check grease dispensing rate, C) reduce remote installation distance, or D) use manual grease gun to clear blockage.

LCD Functions

MODE LOCK

Selecting the dispensing period

Deactivate 'Automatic Lock Out' mode by pressing the button for 2~3 seconds

POWER

Power **ON/OFF**
Press the button for 2 seconds to turn unit **on** of **off**.

125/250 TEST

- A)** To select grease capacity
A short press of the button to select 125ml or 250ml capacity
- B)** To run a test cycle
Hold the button for 2 seconds

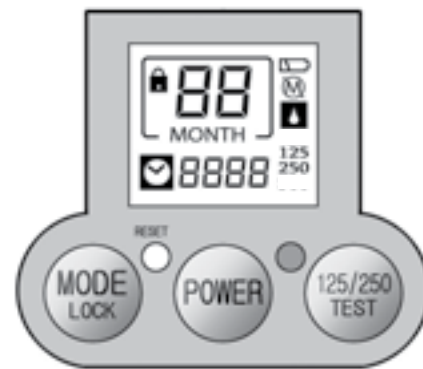

RESET

Reset the unit when the unit malfunctions and/or after changing the Service Pack

LCD Displays



The dispensing period setting

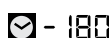

The # of days remaining until the end of lube cycle



The unit is in "Automatic Lock Out" mode

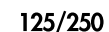

Selected grease pouch capacity

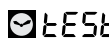

The test mode is activated

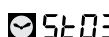

The # of days after dispensing has completed

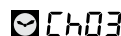

The $\text{\textcircled{M}}$ of days after the unit has stopped dispensing due to excessive backpressure



Low battery power



Excessive backpressure exists



Empty grease level



Signal lamp blinks periodically when battery power is low, excessive backpressure exists, or if grease level is empty

ISO9001/14001 CE

Shelf life and Warranty



LISTED
31VL



EEx nL IIB T5



Ex nL IIB T5 IP54
12-KB2BO-0279X

US 6.354.816
6.498.956
EP1 104 867

The Pulsarlube EX is tested and certified by UL (USA), ATEX (Europe), and KCs (Korea).

Mounting Methods

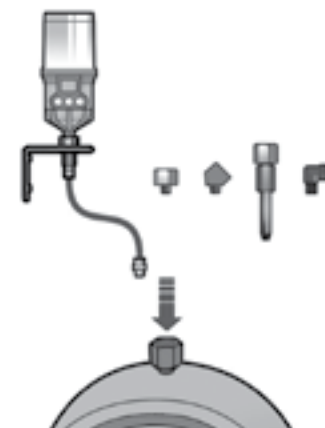

Single Point Installation

Direct Mount or Remote Installation using Extension Tube

Direct mount is always preferable.
For applications not allowing any direct mounts, remotely mount the unit using appropriate accessories and keep the distance from the lube point as short as possible.

For remote installation using a tube, use a 6mm O.D. (1/4") tubing pre-filled with the same or compatible grease as the grease contained in the unit.

Warning

Explosion Hazard - Do not remove or replace batteries unless power has been disconnected or the area is known to be free of ignitable concentrations of flammable gases or vapors.

► Replace Battery With Pulsarlube EX's battery pack only. Use of Another Battery May Present A risk of Fire or Explosion. See Owner's Manual For Safety Instructions.

This equipment is suitable for use in Class I, Division 2, Group C and D hazardous locations. (SUBSTITUTION OF MOTOR AND REED SWITCH MAY IMPAIR SUITABILITY FOR DIVISION 2)

| Reference Designation | Description | Type of Protection |
|-----------------------|-------------|-----------------------|
| M1 | Motor | Non-incendive Circuit |
| SW4 | Reed Switch | Non-incendive Circuit |

Shelf life and Warranty Product Warranty is limited to original defects in material and workmanship and will not cover any collateral damage due to mishandling, abuse and /or any other inappropriate use of this product. Warranty period is 1 year from the date of purchase.

Rev.00

PULSARLUBE

PULSARLUBE

User Manual

Pulsarlube EX

Series

(125 & 250ml)



Pulsarlube U.S.A 1480 Howard Street, Elk Grove Village, IL 60007, USA
TEL:1-847-593-5300 FAX:1-847-593-5303 www.pulsarlube.com / info@pulsarlube.com